

## How to check tracker status:

- 1 Click Trackers icon on bottom of screen. Select Tracker Status. Scan or manually input the tracker/tag ID. Select Tracker Status.
- 2 App returns status of tracker. If it is currently attached to an asset, the asset details will be shown. If unattached, tracker status is shown.

Input a different tracker number to check the status or use the back arrow to return to the Trackers screen.

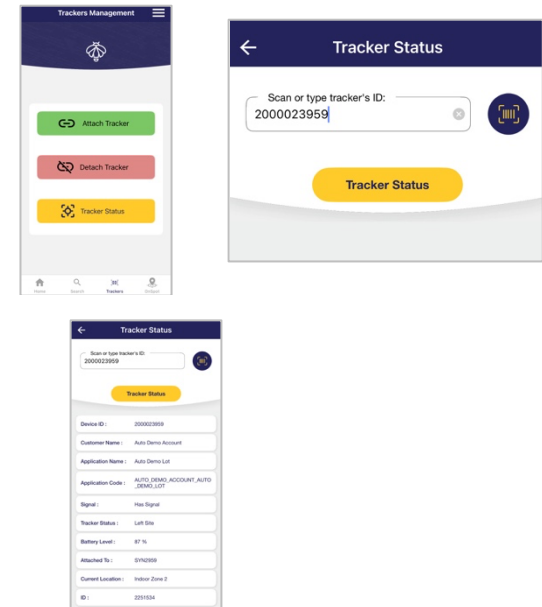

**Need Assistance?** Check out Mobile section of the Logistics Knowledge Base or contact us at [support@cognosos.com](mailto:support@cognosos.com).

## How to attach & detach a tracker to/from an asset:

- 1 **ATTAH:** Click Trackers icon on bottom of screen. Scan or manually input BOTH tracker and asset (e.g., vehicle or trailer) IDs. Select Attach Tracker.

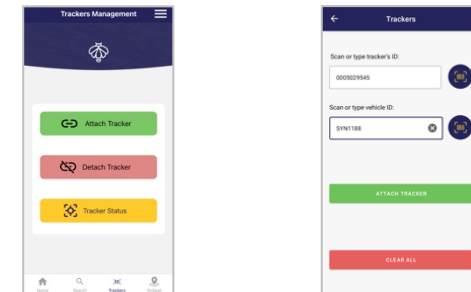

- 2 Input vehicle details. Select Submit. Look for small confirmation message at bottom of window.

*Getting errors when you try to attach? Ensure you are scanning the correct barcode on the tag.*

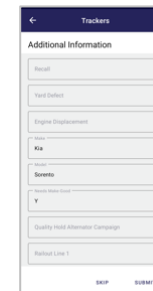

- 1 **DETAH:** Select Detach Tracker on Trackers screen. Scan or type tracker OR asset (e.g., vehicle or trailer) ID. Select Detach Tracker. (Button remains grayed out until tracker ID input.)

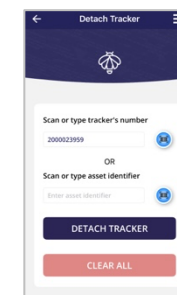

*Detaching removes the association between tag and vehicle. Vehicle is no longer trackable until a new tag is attached.*

**Need Assistance?** Check out Mobile section of the Logistics Knowledge Base or contact us at [support@cognosos.com](mailto:support@cognosos.com).